

x1

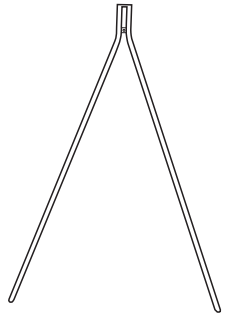

x1

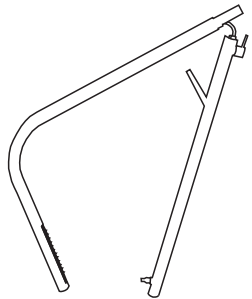

x1



x2



x4

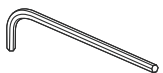

x1

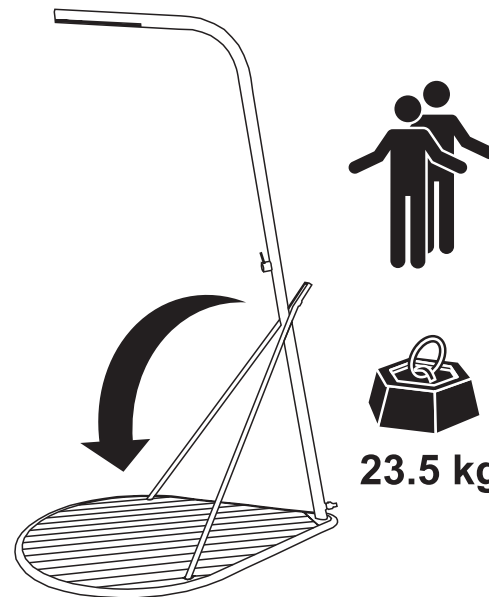
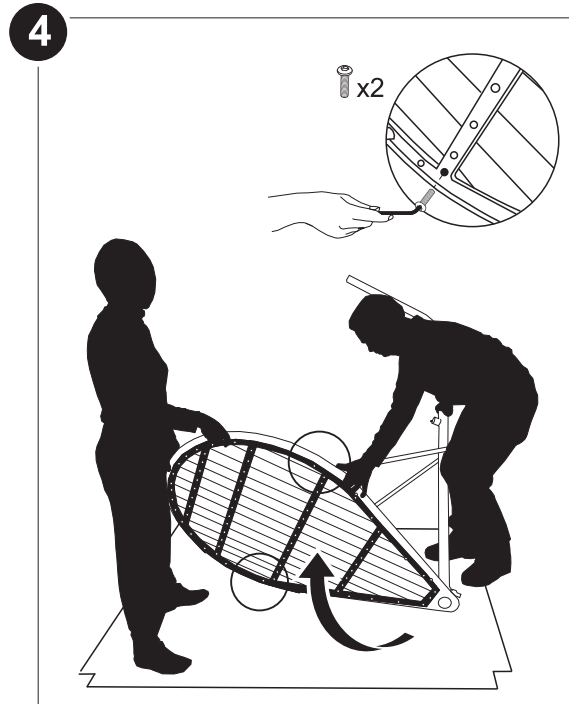
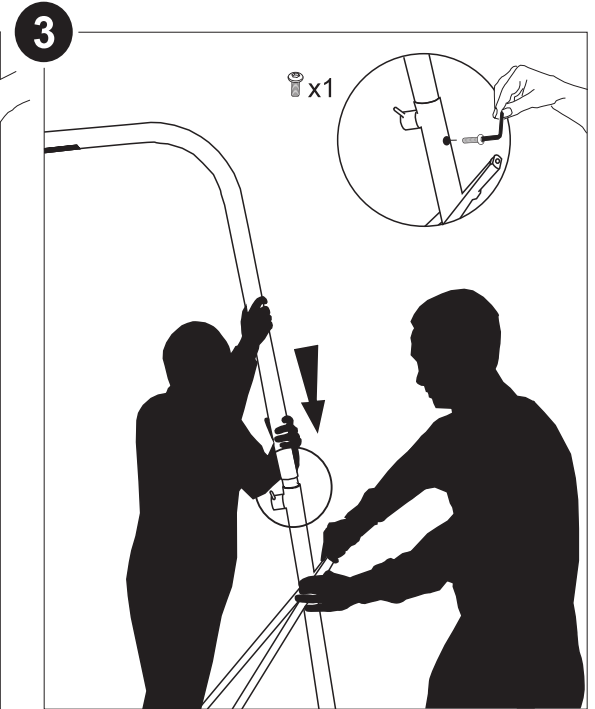
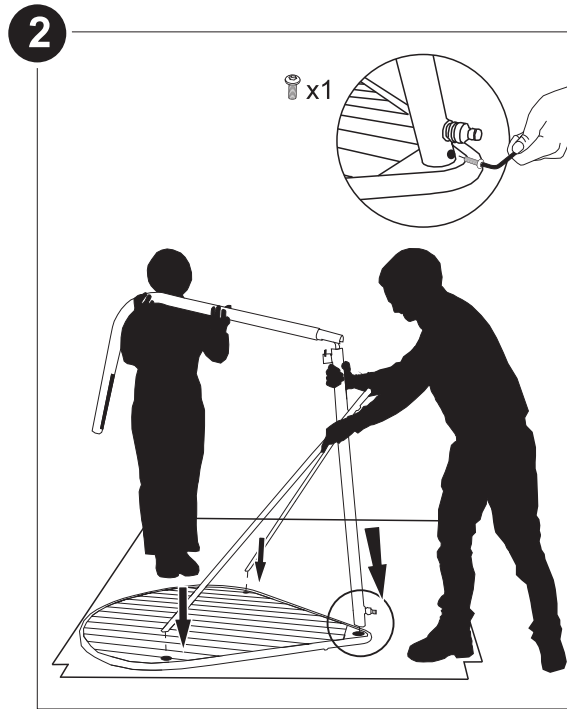
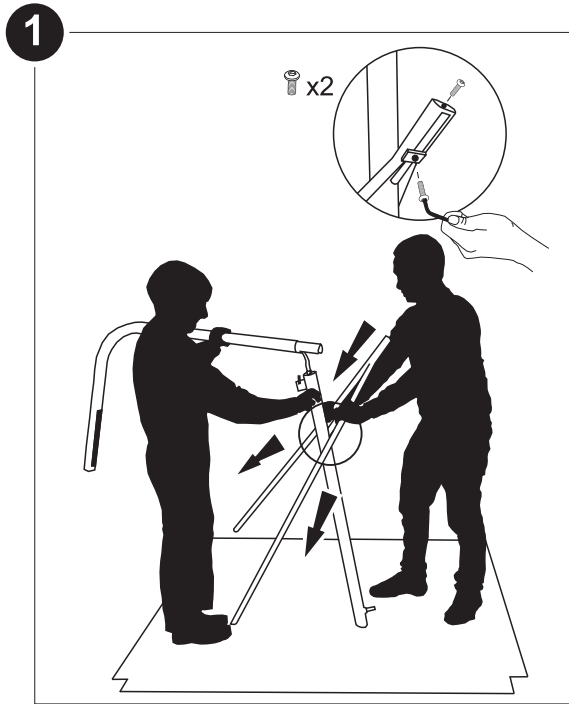

F MISE EN GARDE:

- Ne pas se suspendre à la douche.
- En cas de gel, débrancher le tuyau d'arrosage, mettre en position ouverte le robinet de la douche : il ne doit plus rester d'eau à l'intérieur.

GB WARNING:

- Do not hang from the shower.
- In freezing weather, remove the hose and open the shower tap : no water must remain inside.

D ACHTUNG:

- Sich nicht an die Dusche hängen.
- Bei Frost den Gartenschlauch entfernen und den Wasserhahn der Dusche geöffnet lassen/ es darf kein Wasser im Inneren zurückbleiben.